

**MOBILE CRANE / BOXLOADER RESTRICTIONS
FIPASS NORTH CENTRE BARGE**

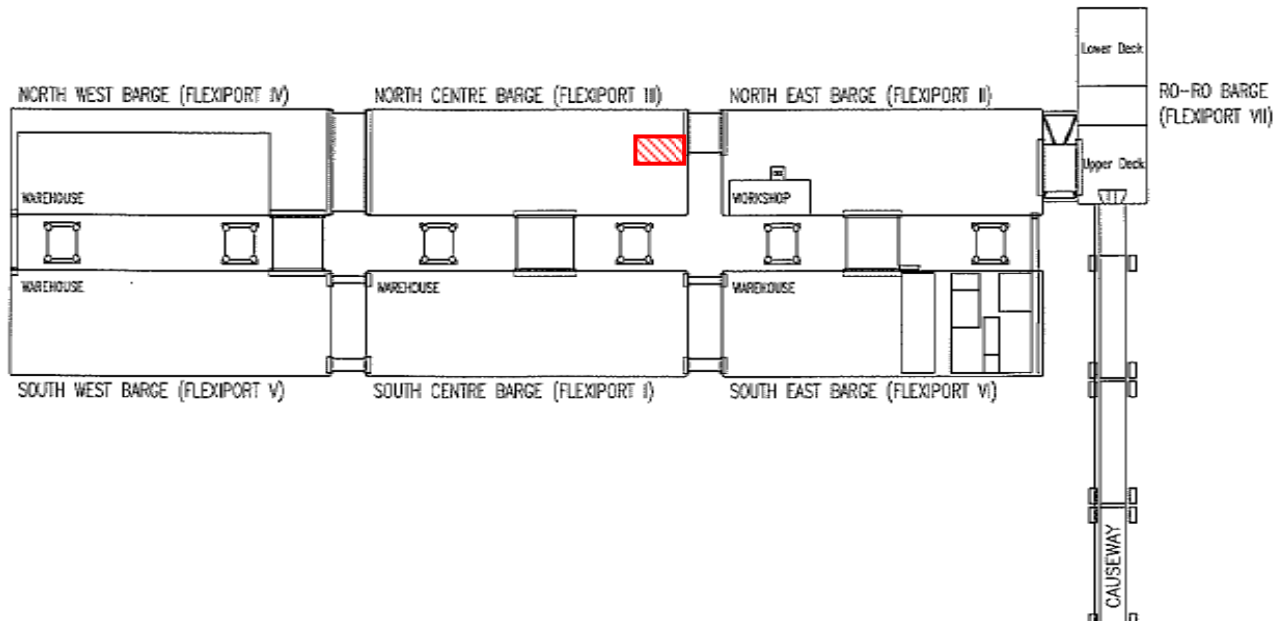

Figure 1: 5 Starboard Inner, North Centre Barge, FIPASS
(Ref: FIPASS SURVEY 2020, ANALYSIS AND RECOMMENDATIONS, MD2052D-2B, page 7).

During a recent engineering deck survey, it has been identified that some of the below deck bulkheads and stiffeners were suffering significant thinning. However, they still maintained sufficient global capacity.

The report concluded that the advanced corrosion from the 2015 report was confirmed in this ballast tank, but there was no physical deformation despite the heavy deterioration. This is the main roadway area and the deck plate and structure were not showing signs of fatigue or damage. Containers were not loaded here but care should be taken not to use the crane above this tank should the requirement arise.

Therefore this Safety Notice is to inform all FIPASS Users that no mobile cranes or boxloader operations are to take place over the area outlined in red on Figure 1 above (5 Starboard Inner). This area will also be clearly identified on the deck, but if in any doubt please speak to the Duty Operations Manager and they will advise accordingly.

Garry Ross
General Manager
Atlink Ltd